

GENERAL NOTES

The Developer/Contractor/Builder is to ensure that the building under construction/alteration is to comply where applicable with the 2010 Building Regulations in respect of all trades involved in the construction of this development.

The Developer/Contractor/Builder should notify ECA of any intended deviations from these plans prior to commencement of development.

All Site Development works to be carried out in accordance with "Recommendations for Site Development Works for Housing Areas" Dept. of Environment.

Contractors must verify all dimensions at the job before commencing any work. No working dimensions to be scaled. This drawing is for the purpose of planning only. Dimensions to blockwork only.

Revision

Date	Rev
31-01-19	A
13-02-19	B
25-09-19	C
25-09-19	D

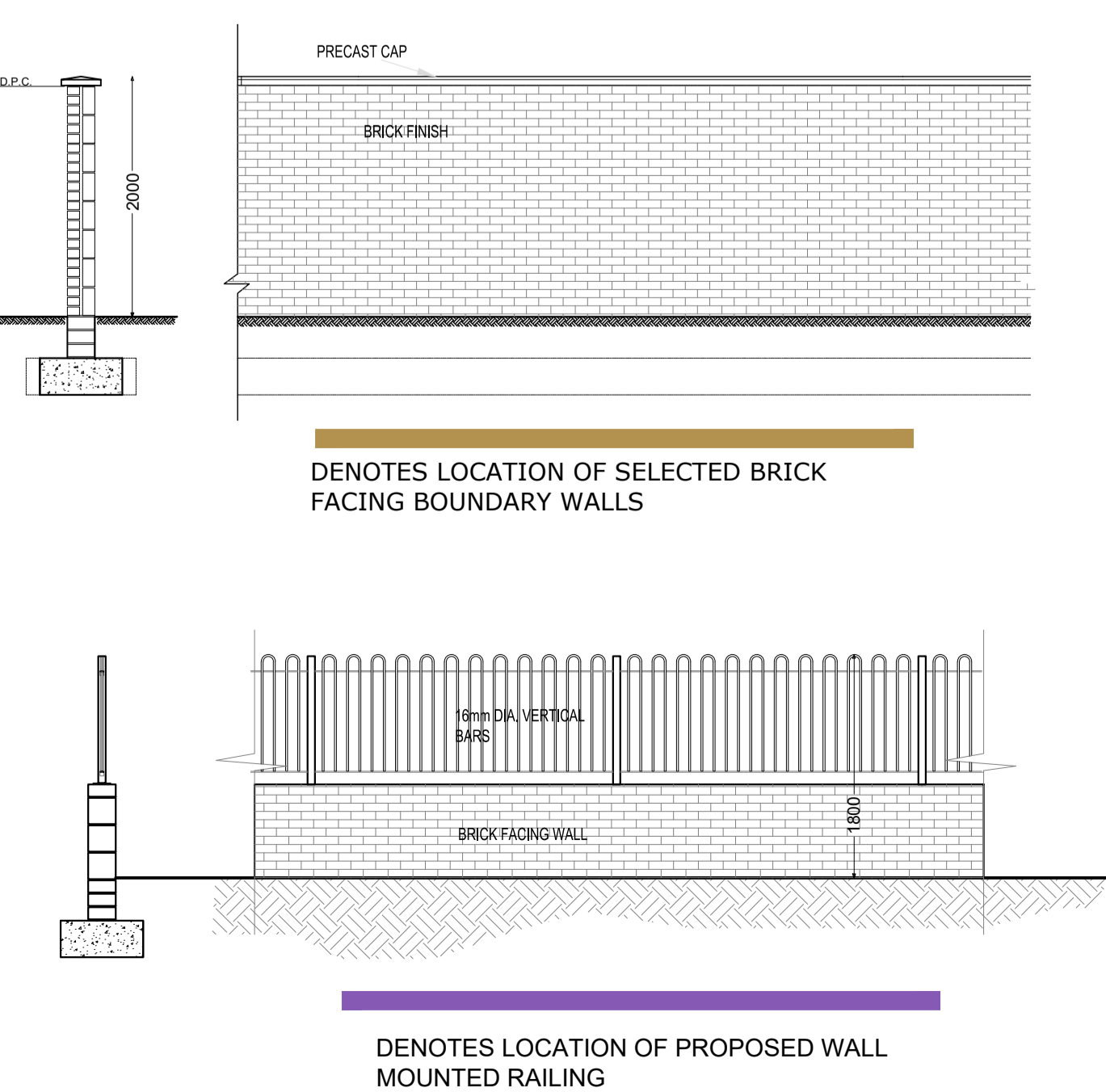
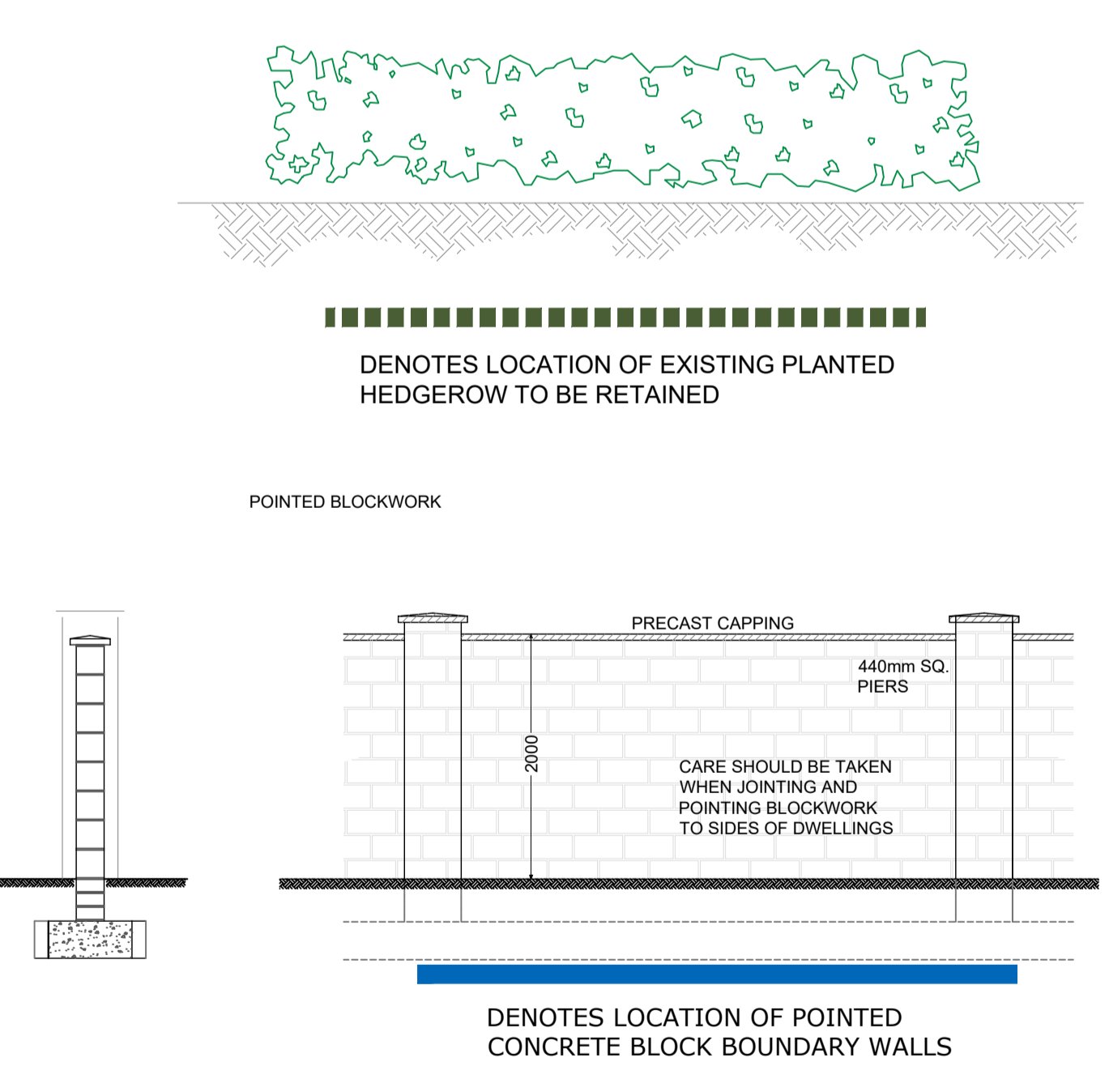
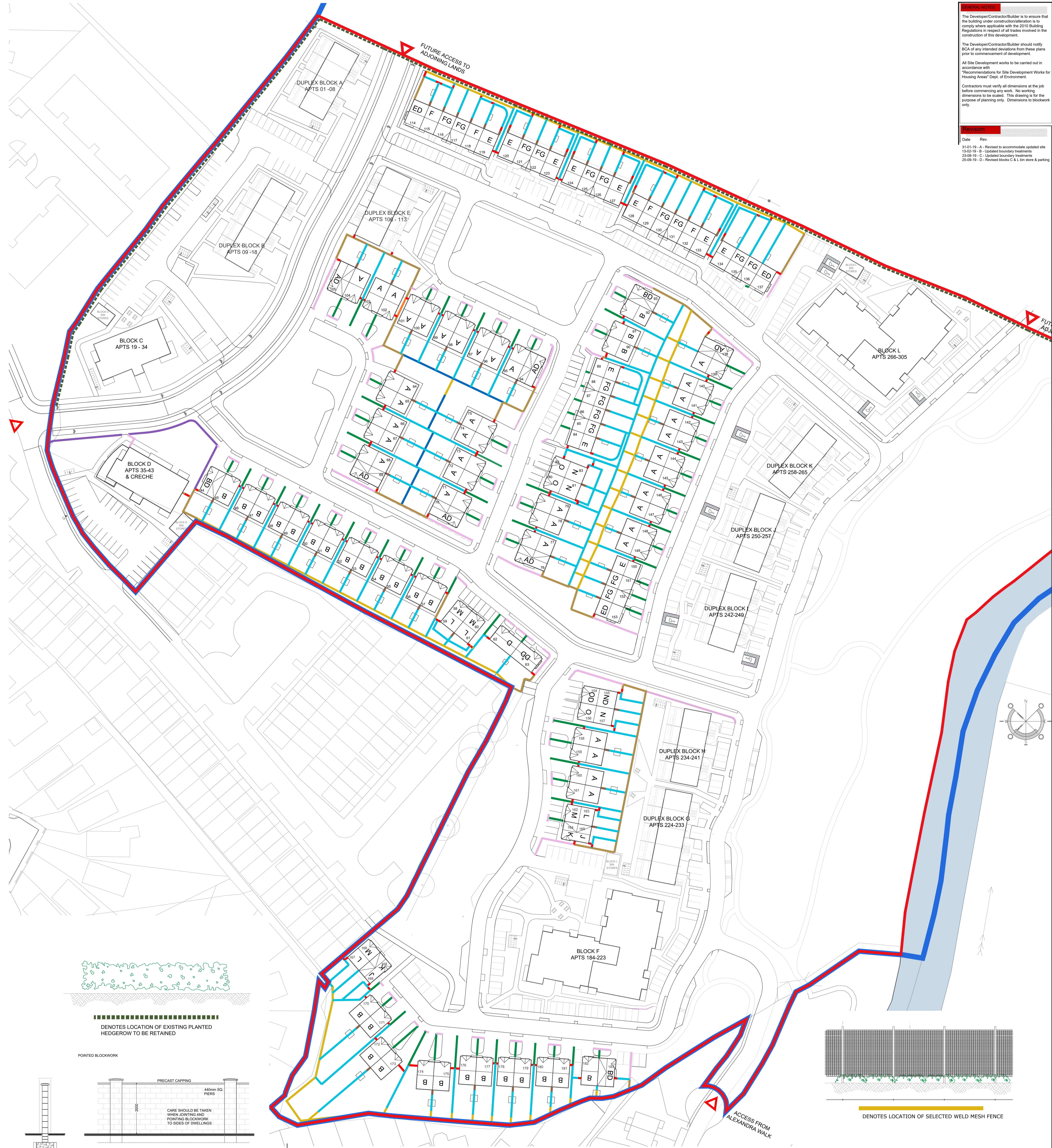

BOUNDARY TREATMENTS

Scale 1:50 @ A0

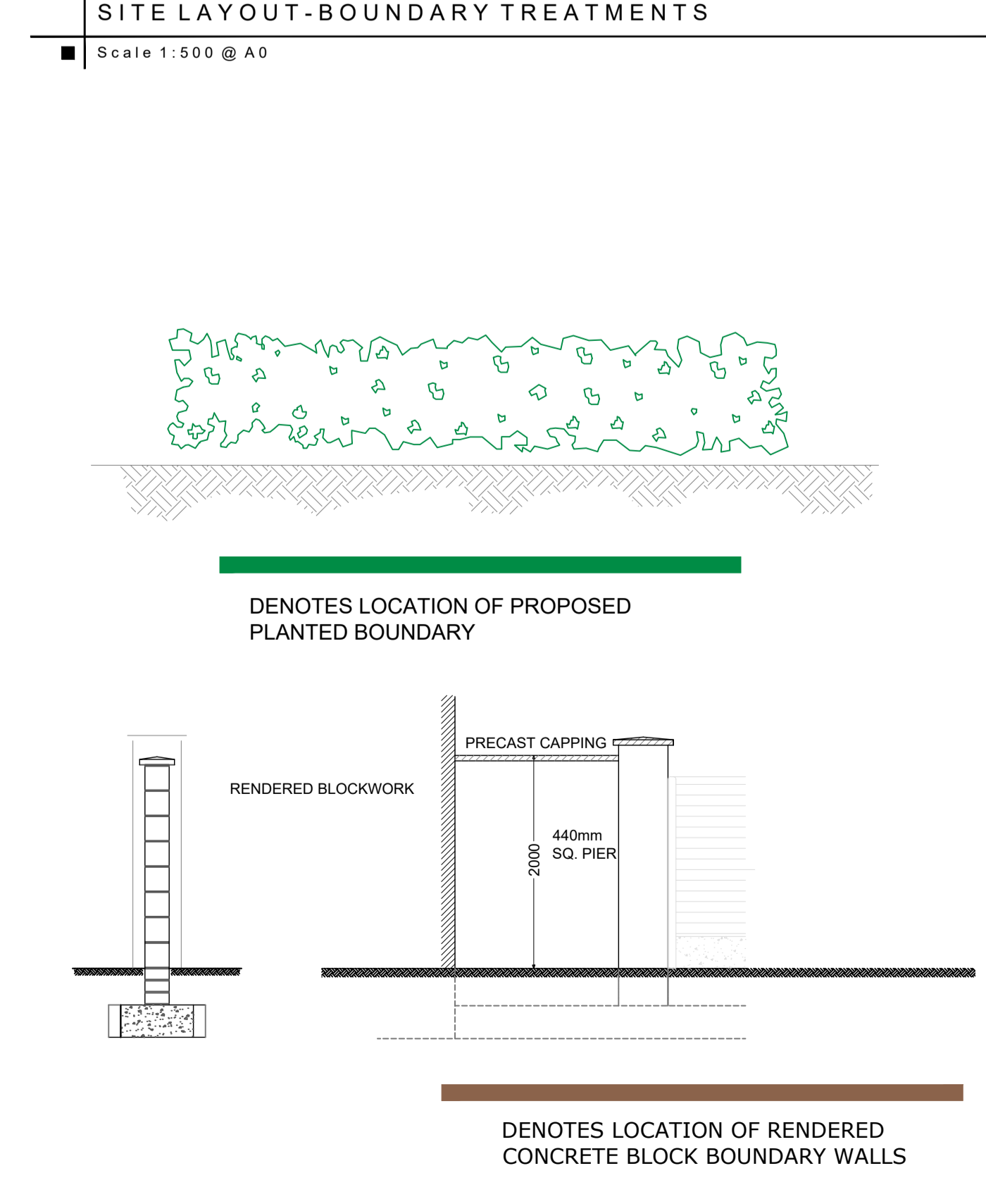

Scale 1:500 @ A0

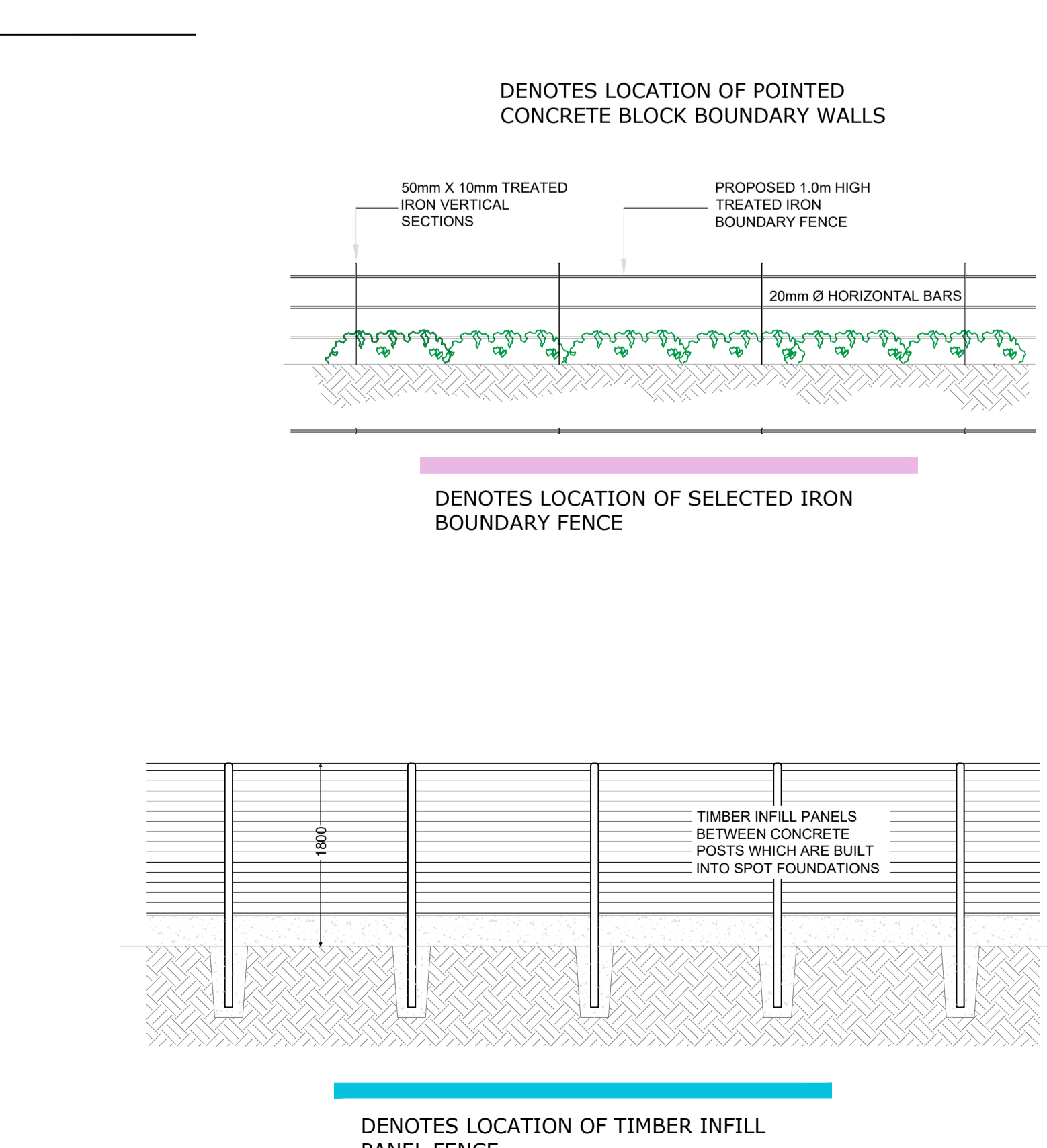

Scale 1:500 @ A0

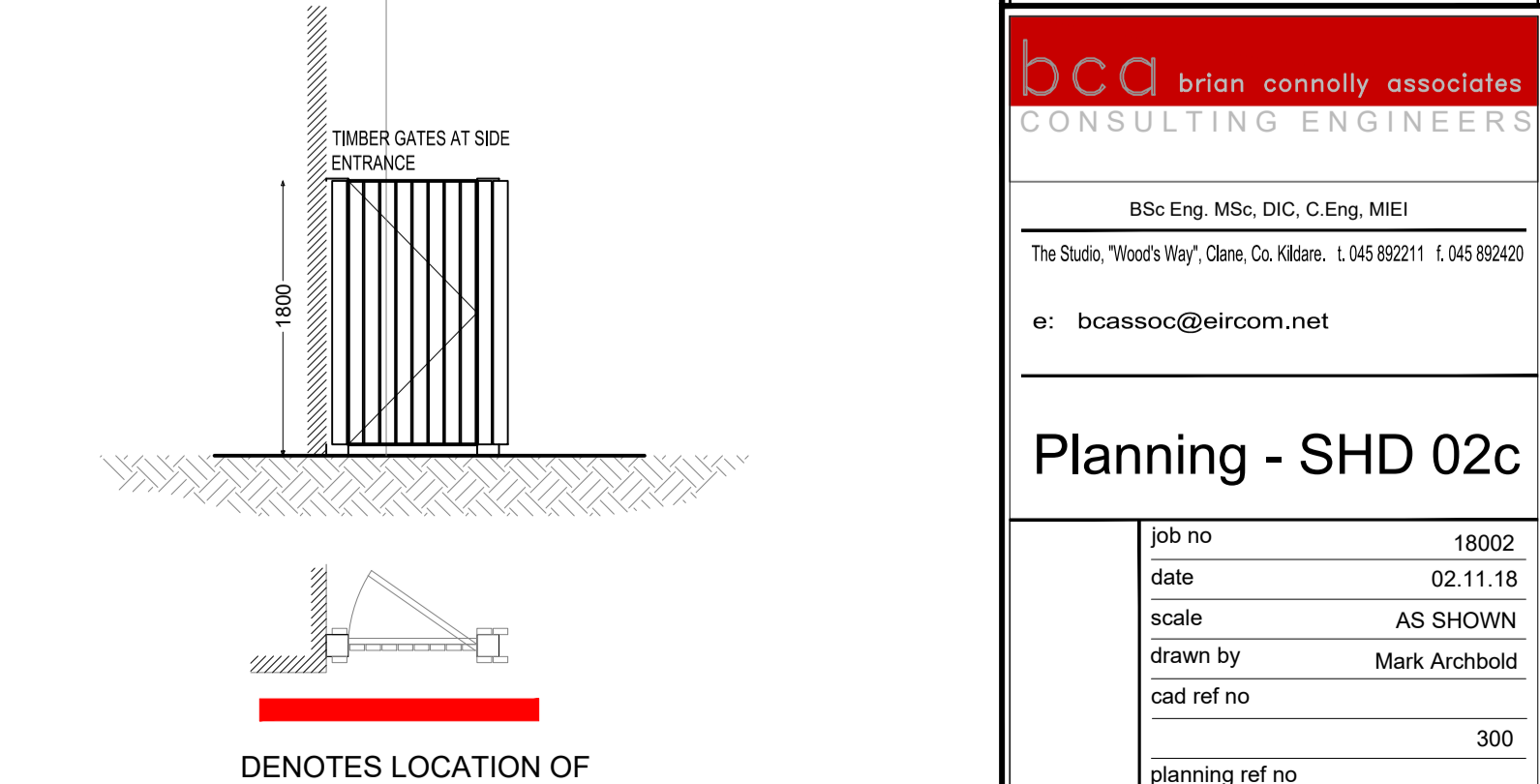
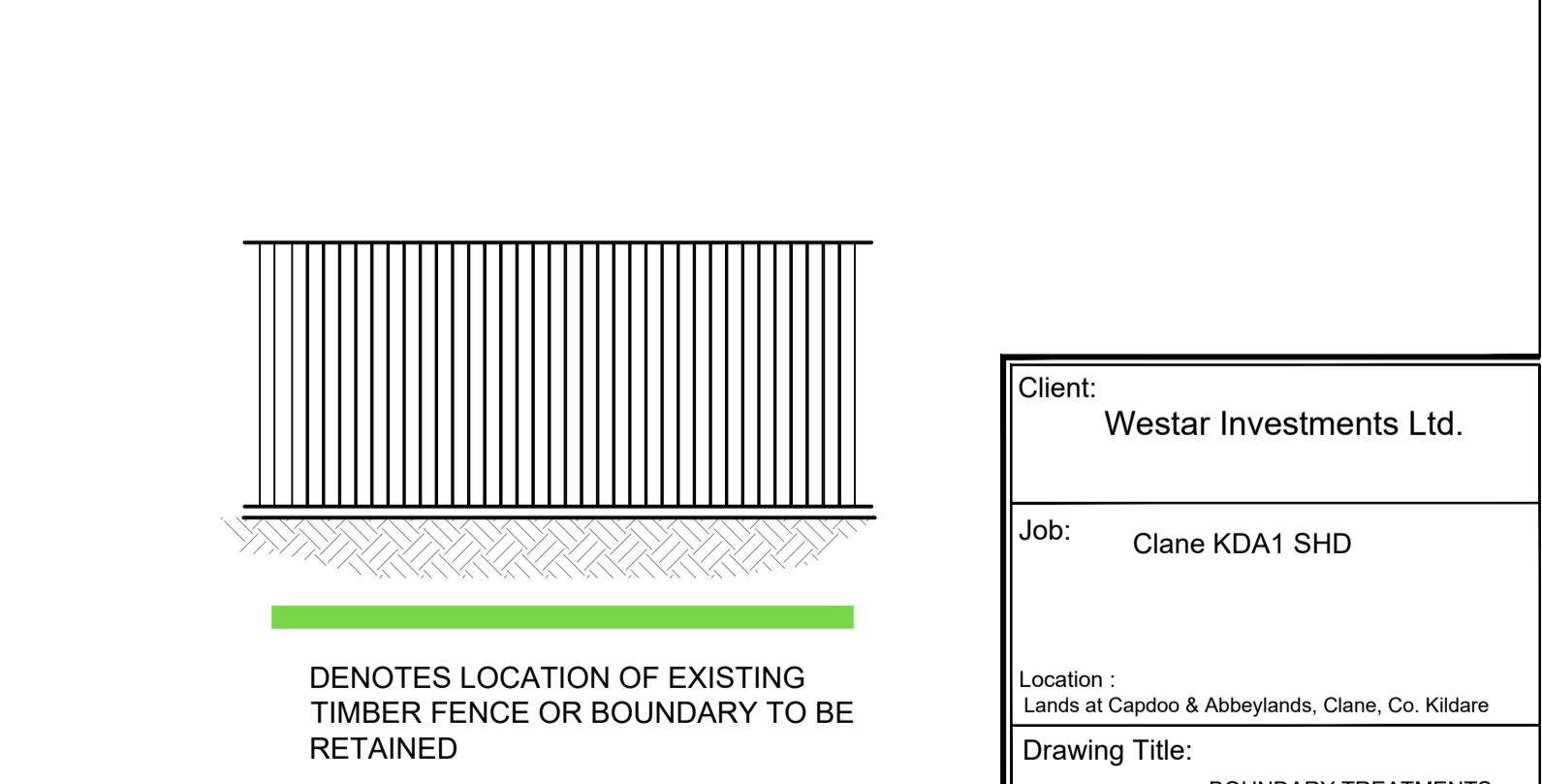
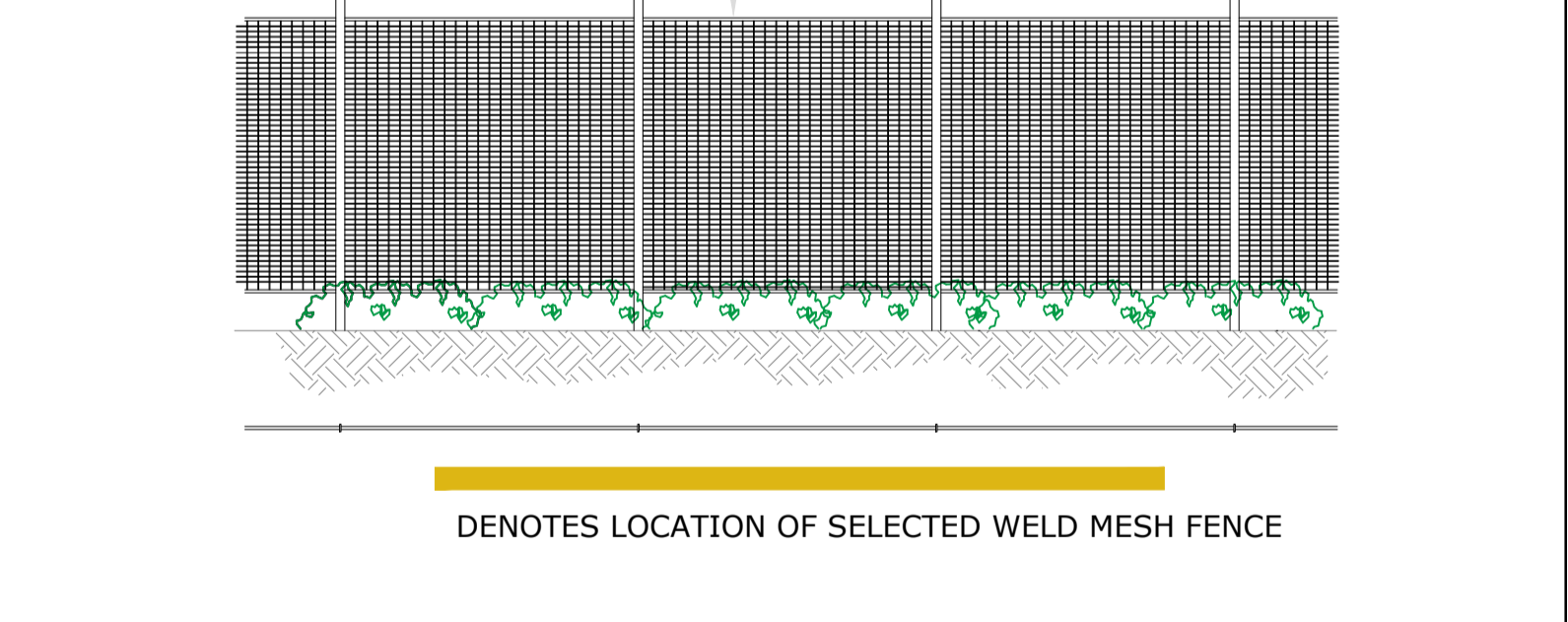

Scale 1:50 @ A0

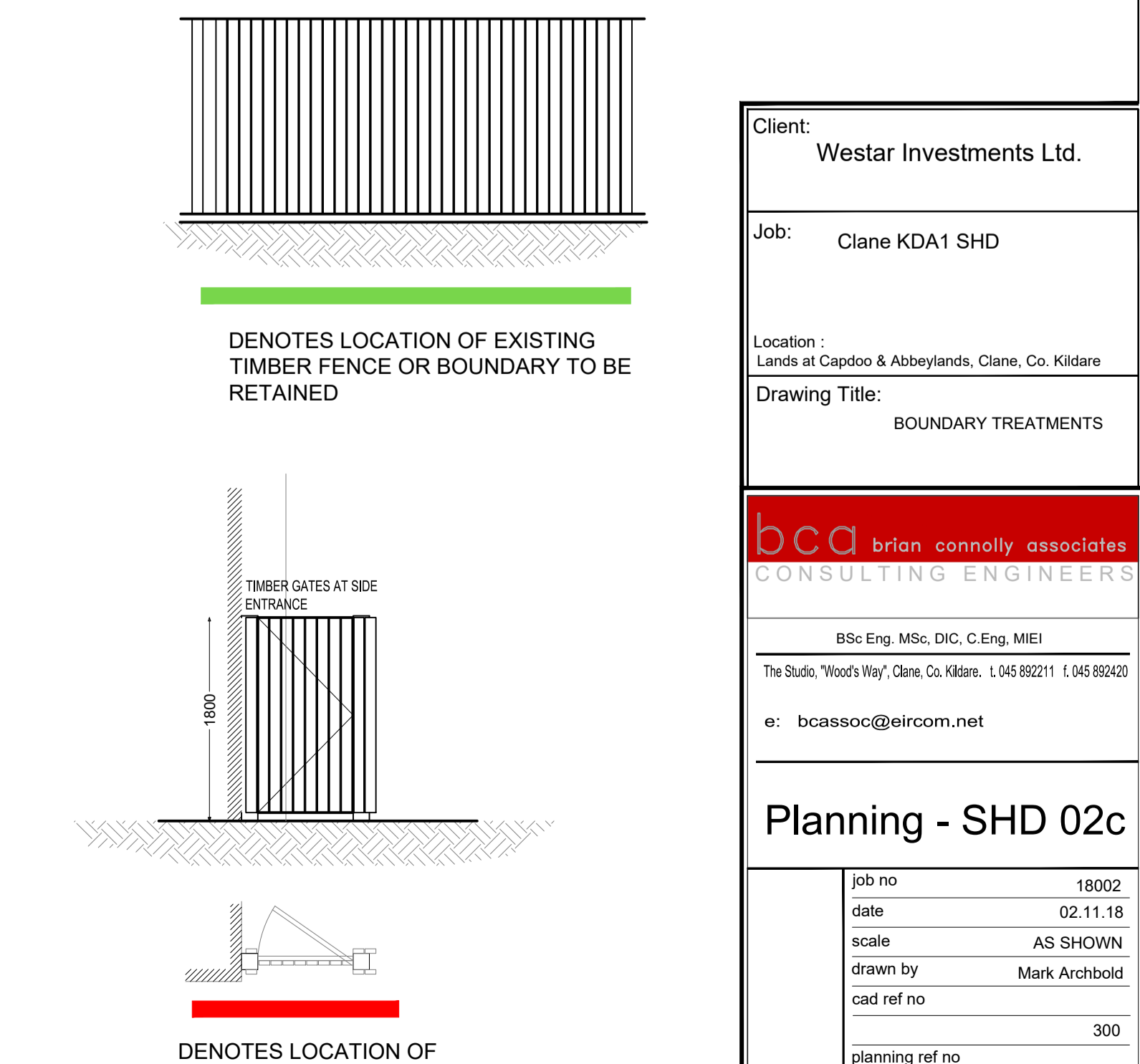

Scale 1:50 @ A0

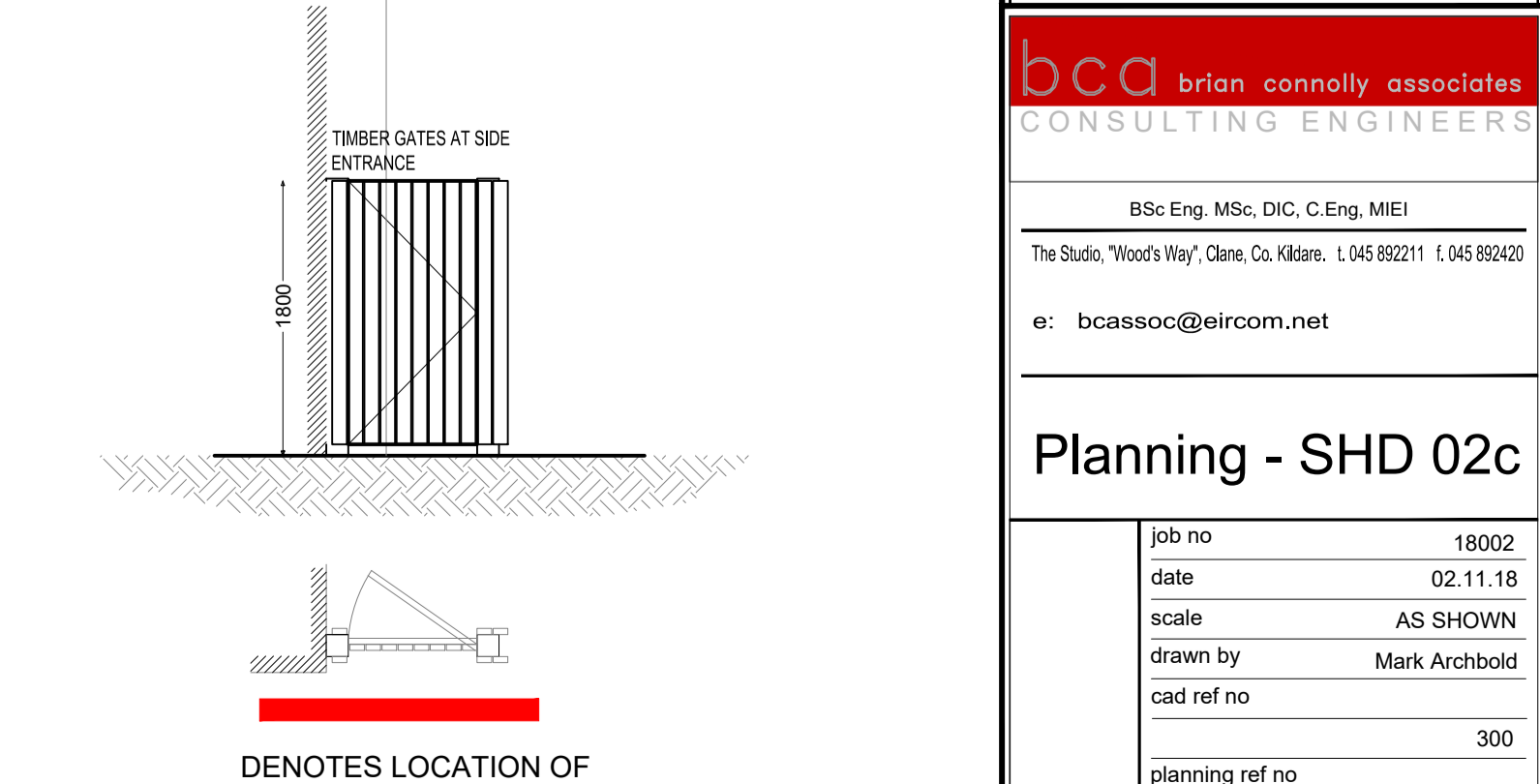

Scale 1:50 @ A0

Client: Westar Investments Ltd.

Job: Clane KDA1 SHD

Location: Lands at Captoe & Abbeylands, Clane, Co. Kildare

Drawing Title: BOUNDARY TREATMENTS

OCCE brian connolly associates
CONSULTING ENGINEERS

BSc Eng. MSc. DIC. C. Eng. MEEI

The Suite, "Wood's Way", Clane Co. Kildare. 15680211 15680202

e: dcasoc@eircom.net

Planning - SHD 02c

job no	18002
date	02.11.18
scale	AS SHOWN
drawn by	Mark Anzibald
cad ref no	
planning ref no	300
file ref no	
drawing no.	304D